

Product Performance

Engine Exhaust Silencers

Typical Attenuation Curves, Standard and Puck-Style Units

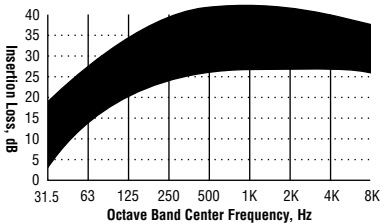
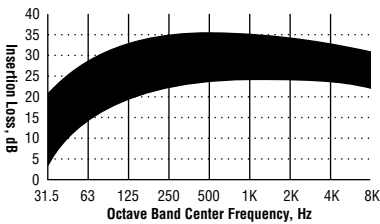
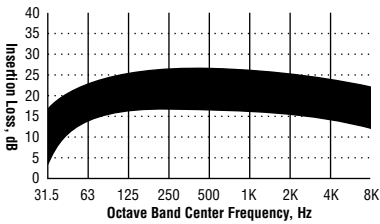
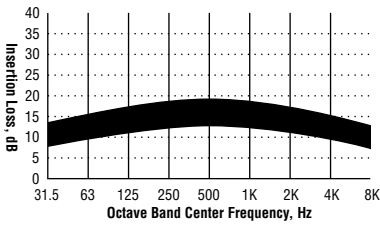

Pressure Drop, Standard Units

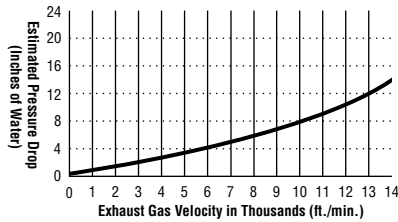

Industrial Grade

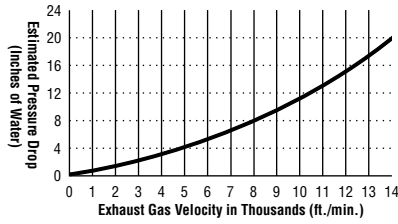

Residential Grade

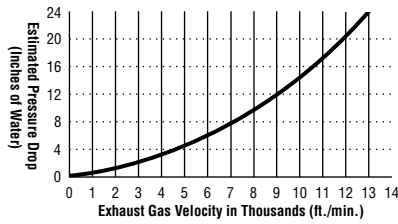

Critical Grade

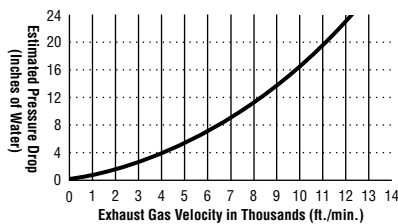

Hospital Grade

Note: When figuring pressure drop for side or middle side inlet, add 3" H₂O to back pressure shown on curve.

Puck-Style

Engine Exhaust Silencers

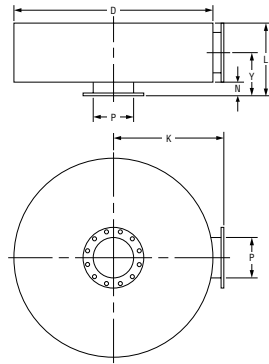

Single Inlet

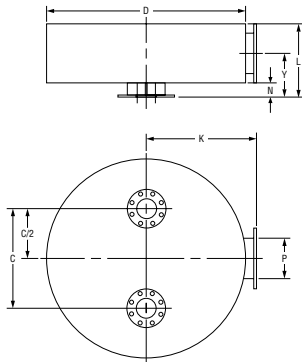

Dual Inlet Type 1

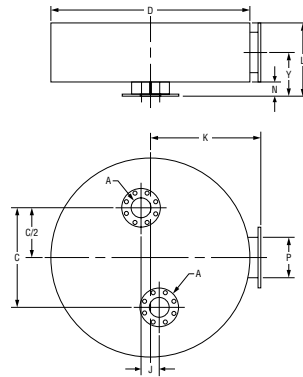

Dual Inlet Type 2

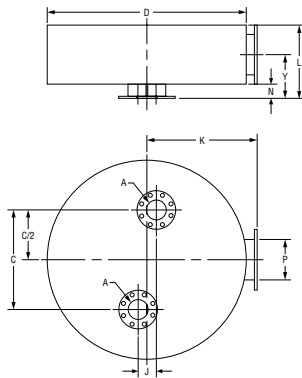

Dual Inlet Type 3

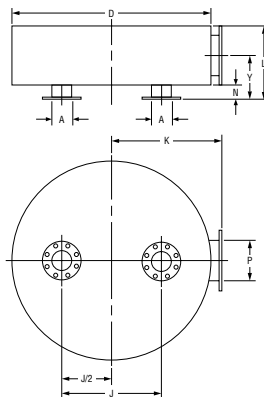

Dual Inlet Type 4

“Puck”-style silencers are low-profile silencers that not only fit in the smallest enclosures, but are also perfect for portable power, marine, or other applications where a “tight fit” is a concern. The single inlet models are available in residential, critical and hospital attenuation grades. Critical and hospital models also offer a low skin temperature (LST) design for exceptionally small compartments and enclosures to keep radiant heat to a minimum. The LST configuration incorporates an extra layer of packed acoustic/thermal insulation that reduces heat and noise, eliminating the need for expensive external wraps. The aluminized steel designs far outperform the comparably priced carbon steel competition by offering higher corrosion resistance, greater maximum operating temperatures, less weight and an overall longer silencer life.

Puck-Style Engine Exhaust Silencers

Single Inlet

	Part Number	P	A	N	D	K	Y	L	C	J	Weight
Residential	42040F	4.0	—	4.0	20.0	14.0	7.0	10.0	—	—	65
	42050F	5.0	—	4.0	21.0	14.5	8.0	12.0	—	—	80
	42060F	6.0	—	4.0	24.0	16.0	8.8	13.5	—	—	100
	42080F	8.0	—	4.0	32.0	20.0	9.5	15.0	—	—	185
	42082F	10.0	—	4.0	38.0	23.0	11.0	18.0	—	—	280
	42084F	12.0	—	4.0	45.0	26.5	12.0	20.0	—	—	415
	42086F	14.0	—	4.0	47.0	27.5	14.5	25.0	—	—	545
	42088F	16.0	—	4.0	54.0	31.0	15.5	27.0	—	—	660
	42099F	18.0	—	4.0	62.0	35.0	16.5	29.0	—	—	825
Critical	43040F	4.0	—	4.0	26.0	17.0	7.5	11.0	—	—	110
	43050F	5.0	—	4.0	27.0	17.5	8.0	12.0	—	—	140
	43060F	6.0	—	4.0	31.0	19.5	8.8	13.5	—	—	190
	43080F	8.0	—	4.0	43.0	25.5	9.5	15.0	—	—	355
	43082F	10.0	—	4.0	50.0	29.0	11.0	18.0	—	—	515
	43084F	12.0	—	4.0	60.0	34.0	12.0	20.0	—	—	710
	43086F	14.0	—	4.0	62.4	35.2	14.5	25.0	—	—	855
	43088F	16.0	—	4.0	72.4	40.2	15.5	27.0	—	—	1,180
	43099F	18.0	—	4.0	82.6	45.3	16.5	29.0	—	—	1,450
	44040F	4.0	—	4.0	30.0	19.0	8.0	12.0	—	—	146
	44050F	5.0	—	4.0	30.0	19.0	8.5	13.0	—	—	175
	44060F	6.0	—	4.0	36.0	22.0	8.8	13.5	—	—	235
Hospital	44080F	8.0	—	4.0	50.0	29.0	9.5	15.0	—	—	492
	44082F	10.0	—	4.0	57.0	32.5	11.0	18.0	—	—	672
	44084F	12.0	—	4.0	68.0	38.0	12.0	20.0	—	—	908
	44086F	14.0	—	4.0	68.0	38.0	14.8	25.5	—	—	1,039
	44088F	16.0	—	4.0	73.0	40.5	17.0	30.0	—	—	1,238
	44099F	18.0	—	4.0	84.0	46.0	18.0	32.0	—	—	1,597

Single Inlet, Low Skin Temperature (LST)

	Part Number	P	A	N	D	K	Y	L	C	J	Weight
Critical	47040F	4.0	—	4.0	28.0	18.0	8.5	13.0	—	—	125
	47050F	5.0	—	4.0	29.0	18.5	9.0	14.0	—	—	160
	47060F	6.0	—	4.0	33.0	20.5	9.8	15.5	—	—	215
	47080F	8.0	—	4.0	45.0	26.5	10.5	17.0	—	—	375
	47082F	10.0	—	4.0	52.0	30.0	12.0	20.0	—	—	565
	47084F	12.0	—	4.0	62.0	35.0	13.0	22.0	—	—	800
	47086F	14.0	—	4.0	64.4	36.2	15.5	27.0	—	—	955
	47088F	16.0	—	4.0	74.4	41.2	16.5	29.0	—	—	1,310
	47099F	18.0	—	4.0	84.6	46.3	17.5	31.0	—	—	1,630
Hospital	48040F	4.0	—	4.0	32.0	20.0	9.0	14.0	—	—	170
	48050F	5.0	—	4.0	32.0	20.0	9.5	15.0	—	—	195
	48060F	6.0	—	4.0	38.0	23.0	9.8	15.5	—	—	276
	48080F	8.0	—	4.0	52.0	30.0	10.5	17.0	—	—	550
	48082F	10.0	—	4.0	59.0	33.5	12.0	20.0	—	—	756
	48084F	12.0	—	4.0	70.0	39.0	13.0	22.0	—	—	1,005
	48086F	14.0	—	4.0	70.0	39.0	15.8	27.5	—	—	1,144
	48088F	16.0	—	4.0	75.0	41.5	18.0	32.0	—	—	1,364
	48099F	18.0	—	4.0	86.0	47.0	19.0	34.0	—	—	1,755

Puck-Style

Engine Exhaust Silencers

Dual Inlet

Part Number	Fits Engine	Silencer Type	P	A	N	D	K	Y	L	C	J	Weight
431CA684F	CAT 3508B	1	12.0	6.0	4.0	60.0	34.0	12.0	20.0	20.5	—	706
431CA884F	CAT 3508B	1	12.0	8.0	4.0	60.0	34.0	12.0	20.0	20.5	—	704
431CB886F	CAT 3512B	1	14.0	8.0	4.0	62.4	35.2	14.5	25.0	20.6	—	855
431CB086F	CAT 3512B	1	14.0	10.0	4.0	62.4	35.2	14.5	25.0	20.6	—	863
431CB888F	CAT 3512B	1	16.0	8.0	4.0	72.4	40.2	15.5	27.0	20.6	—	1,174
431CB088F	CAT 3512B	1	16.0	10.0	4.0	72.4	40.2	15.5	27.0	20.6	—	1,182
431CC886F	CAT 3516	1	14.0	8.0	4.0	62.4	35.2	14.5	25.0	20.5	—	855
431CC086F	CAT 3516	1	14.0	10.0	4.0	62.4	35.2	14.5	25.0	20.5	—	863
431CC888F	CAT 3516	1	16.0	8.0	4.0	72.4	40.2	15.5	27.0	20.5	—	1,174
431CC088F	CAT 3516	1	16.0	10.0	4.0	72.4	40.2	15.5	27.0	20.5	—	1,180
431CC899F	CAT 3516	1	18.0	8.0	4.0	82.6	45.3	16.5	29.0	20.5	—	1,443
431CC099F	CAT 3516	1	18.0	10.0	4.0	82.6	45.3	16.5	29.0	20.5	—	1,451
433MA580F	Cummins VTA28-G5	3	8.0	5.0	4.0	43.0	25.5	9.5	15.0	12.5	—	357
433MA582F	Cummins VTA28-G5	3	10.0	5.0	4.0	50.0	29.0	11.0	18.0	12.5	2.0	513
432MB682F	Cummins QST30-G1-2	2	10.0	6.0	4.0	50.0	29.0	11.0	18.0	12.1	2.0	519
432MC682F	Cummins QST30-G3	2	10.0	6.0	4.0	50.0	29.0	11.0	18.0	13.3	4.2	519
432MD684F	Cummins QST30-G3-5	2	12.0	6.0	4.0	60.0	34.0	12.0	20.0	13.3	4.2	706
432ME682F	Cummins KTA38-G3	2	10.0	6.0	4.0	50.0	29.0	11.0	18.0	13.3	4.2	519
432MF684F	Cummins KTA38-G3-5	2	12.0	6.0	4.0	60.0	34.0	12.0	20.0	13.3	5.7	706
433MG684F	Cummins KTA50-G3	3	12.0	6.0	4.0	60.0	34.0	12.0	20.0	10.3	5.7	706
433MH686F	Cummins KTA50-G3-4	3	14.0	6.0	4.0	62.4	35.2	14.5	25.0	10.3	13.9	847
433MJ686F	Cummins KTA50-G9	3	14.0	6.0	4.0	62.4	35.2	14.5	25.0	10.3	13.9	847
434KA086F	DD/Kohler 12V 4000	4	14.0	10.0	4.0	62.4	35.2	14.5	25.0	—	13.9	863
434KA088F	DD/Kohler 12V 4000	4	16.0	10.0	4.0	72.4	40.2	15.5	27.0	—	18.5	1,182
441CA684F	CAT 3508B	1	12.0	6.0	4.0	68.0	38.0	12.0	20.0	20.5	18.5	904
441CA884F	CAT 3508B	1	12.0	8.0	4.0	68.0	38.0	12.0	20.0	20.5	—	902
441CB886F	CAT 3512B	1	14.0	8.0	4.0	68.0	38.0	14.8	25.5	20.6	—	1,039
441CB086F	CAT 3512B	1	14.0	10.0	4.0	68.0	38.0	14.8	25.5	20.6	—	1,047
441CB888F	CAT 3512B	1	16.0	8.0	4.0	73.0	40.5	17.0	30.0	20.6	—	1,232
441CB088F	CAT 3512B	1	16.0	10.0	4.0	73.0	40.5	17.0	30.0	20.6	—	1,240
441CC886F	CAT 3516	1	14.0	8.0	4.0	68.0	38.0	14.8	25.5	20.5	—	1,047
441CC086F	CAT 3516	1	14.0	10.0	4.0	68.0	38.0	14.8	25.5	20.5	—	1,047
441CC888F	CAT 3516	1	16.0	8.0	4.0	73.0	40.5	17.0	30.0	20.5	—	1,232
441CC088F	CAT 3516	1	16.0	10.0	4.0	73.0	40.5	17.0	30.0	20.5	—	1,238
441CC899F	CAT 3516	1	18.0	8.0	4.0	84.0	46.0	18.0	32.0	20.5	—	1,590
441CC099F	CAT 3516	1	18.0	10.0	4.0	84.0	46.0	18.0	32.0	20.5	—	1,598
443MA580F	Cummins VTA28-G	3	8.0	5.0	4.0	50.0	29.0	9.5	15.0	12.5	—	494
443MA582F	Cummins VTA28-G5	3	10.0	5.0	4.0	57.0	32.5	11.0	18.0	12.5	2.0	670
442MB682F	Cummins QST30-G1-2	2	10.0	6.0	4.0	57.0	32.5	11.0	18.0	12.1	2.0	676
442MC682F	Cummins QST30-G3	2	10.0	6.0	4.0	57.0	32.5	11.0	18.0	13.3	4.2	676
442MD684F	Cummins QST30-G3-5	2	12.0	6.0	4.0	68.0	38.0	12.0	20.0	13.3	4.2	904
442ME682F	Cummins KTA38-G3	2	10.0	6.0	4.0	57.0	32.5	11.0	18.0	13.3	4.2	676
442MF684F	Cummins KTA38-G3-5	2	12.0	6.0	4.0	68.0	38.0	12.0	20.0	13.3	5.8	904
443MG684F	Cummins KTA50-G3	3	12.0	6.0	4.0	68.0	38.0	12.0	20.0	10.3	5.7	904
443MH686F	Cummins KTA50-G3-4	3	14.0	6.0	4.0	68.0	38.0	14.8	25.5	10.3	13.9	1,031
443MJ686F	Cummins KTA50-G9	3	14.0	6.0	4.0	68.0	38.0	14.8	25.5	10.3	13.9	1,031
444KA086F	DD/Kohler 12V 4000	4	14.0	10.0	4.0	68.0	38.0	14.8	25.5	—	13.9	1,047
444KA088F	DD/Kohler 12V 4000	4	16.0	10.0	4.0	73.0	40.5	17.0	30.0	—	18.5	1,240

Critical

Hospital

Puck-Style

Engine Exhaust Silencers

Dual Inlet, Flush Mount

Part Number	Fits Engine	Silencer Type	P	A	N	D	K	Y	L	C	J	Weight
431CA684S	CAT 3508B	1	12.0	6.0	0.5	60.0	34.0	8.5	16.5	20.5	—	700
431CA884S	CAT 3508B	1	12.0	8.0	0.5	60.0	34.0	8.5	16.5	20.5	—	698
431CB886S	CAT 3512B	1	14.0	8.0	0.5	62.4	35.2	11.0	21.5	20.6	—	847
431CB086S	CAT 3512B	1	14.0	10.0	0.6	62.4	35.2	11.1	21.6	20.6	—	853
431CB888S	CAT 3512B	1	16.0	8.0	0.5	72.4	40.2	12.0	23.5	20.6	—	1,166
431CB088S	CAT 3512B	1	16.0	10.0	0.6	72.4	40.2	12.1	23.6	20.6	—	1,172
431CC886S	CAT 3516	1	14.0	8.0	0.5	62.4	35.2	11.0	21.5	20.5	—	847
431CC086S	CAT 3516	1	14.0	10.0	0.6	62.4	35.2	11.1	21.6	20.5	—	853
431CC888S	CAT 3516	1	16.0	8.0	0.5	72.4	40.2	12.0	23.5	20.5	—	1,166
431CC088S	CAT 3516	1	16.0	10.0	0.6	72.4	40.2	12.1	23.6	20.5	—	1,170
431CC899S	CAT 3516	1	18.0	8.0	0.5	82.6	45.3	13.0	25.5	20.5	—	1,435
431CC099S	CAT 3516	1	18.0	10.0	0.6	82.6	45.3	13.1	25.6	20.5	—	1,441
433MA580S	Cummins VTA28-G5	3	8.0	5.0	0.5	43.0	25.5	6.0	11.5	12.5	2.0	352
433MA582S	Cummins VTA28-G5	3	10.0	5.0	0.5	50.0	29.0	7.5	14.5	12.5	2.0	508
432MB682S	Cummins QST30-G1-2	2	10.0	6.0	0.5	50.0	29.0	7.5	14.5	12.1	4.2	513
432MC682S	Cummins QST30-G3	2	10.0	6.0	0.5	50.0	29.0	7.5	14.5	13.3	4.2	513
432MD684S	Cummins QST30-G3-5	2	12.0	6.0	0.5	60.0	34.0	8.5	16.5	13.3	4.2	700
432ME682S	Cummins KTA38-G3	2	10.0	6.0	0.5	50.0	29.0	7.5	14.5	13.3	5.7	513
432MF684S	Cummins KTA38-G3-5	2	12.0	6.0	0.5	60.0	34.0	8.5	16.5	13.3	5.7	700
433MG684S	Cummins KTA50-G3	3	12.0	6.0	0.5	60.0	34.0	8.5	16.5	10.3	13.9	700
433MH686S	Cummins KTA50-G3-4	3	14.0	6.0	0.5	62.4	35.2	11.0	21.5	10.3	13.9	841
433MJ686S	Cummins KTA50-G9	3	14.0	6.0	0.5	62.4	35.2	11.0	21.5	10.3	13.9	841
434KA086S	DD/Kohler 12V 4000	4	14.0	10.0	0.6	62.4	35.2	11.1	21.6	—	18.5	853
434KA088S	DD/Kohler 12V 4000	4	16.0	10.0	0.6	72.4	40.2	12.1	23.6	—	18.5	1,172
441CA684S	CAT 3508B	1	12.0	6.0	0.5	68.0	34.0	8.5	16.5	20.5	—	898
441CA884S	CAT 3508B	1	12.0	8.0	0.5	68.0	34.0	8.5	16.5	20.5	—	896
441CB886S	CAT 3512B	1	14.0	8.0	0.5	68.0	34.0	11.3	22.0	20.6	—	1,031
441CB086S	CAT 3512B	1	14.0	10.0	0.6	68.0	34.0	11.4	22.1	20.6	—	1,037
441CB888S	CAT 3512B	1	16.0	8.0	0.5	73.0	36.5	13.5	26.5	20.6	—	1,224
441CB088S	CAT 3512B	1	16.0	10.0	0.6	73.0	36.5	13.6	26.6	20.6	—	1,230
441CC886S	CAT 3516	1	14.0	8.0	0.5	68.0	34.0	11.3	22.0	20.5	—	1,039
441CC086S	CAT 3516	1	14.0	10.0	0.6	68.0	34.0	11.4	22.1	20.5	—	1,037
441CC888S	CAT 3516	1	16.0	8.0	0.5	73.0	36.5	13.5	26.5	20.5	—	1,224
441CC088S	CAT 3516	1	16.0	10.0	0.6	73.0	36.5	13.6	26.6	20.5	—	1,228
441CC899S	CAT 3516	1	18.0	8.0	0.5	84.0	42.0	14.5	28.5	20.5	—	1,582
441CC099S	CAT 3516	1	18.0	10.0	0.6	84.0	42.0	14.6	28.6	20.5	—	1,588
443MA580S	Cummins VTA28-G5	3	8.0	5.0	0.5	50.0	25.0	6.0	11.5	12.5	2.0	489
443MA582S	Cummins VTA28-G5	3	10.0	5.0	0.5	57.0	28.5	7.5	14.5	12.5	2.0	665
442MB682S	Cummins QST30-G1-2	2	10.0	6.0	0.5	57.0	28.5	7.5	14.5	12.1	4.2	670
442MC682S	Cummins QST30-G3	2	10.0	6.0	0.5	57.0	28.5	7.5	14.5	13.3	4.2	670
442MD684S	Cummins QST30-G3-5	2	12.0	6.0	0.5	68.0	34.0	8.5	16.5	13.3	4.2	898
442ME682S	Cummins KTA38-G3	2	10.0	6.0	0.5	57.0	32.5	7.5	14.5	13.3	5.7	670
442MF684S	Cummins KTA38-G3-5	2	12.0	6.0	0.5	68.0	38.0	8.5	16.5	13.3	5.7	898
443MG684S	Cummins KTA50-G3	3	12.0	6.0	0.5	68.0	34.0	8.5	16.5	10.3	13.9	898
443MH686S	Cummins KTA50-G3-4	3	14.0	6.0	0.5	68.0	34.0	11.3	22.0	10.3	13.9	1,025
443MJ686S	Cummins KTA50-G9	3	14.0	6.0	0.5	68.0	34.0	11.3	22.0	10.3	13.9	1,025
444KA086S	DD/Kohler 12V 4000	4	14.0	10.0	0.6	68.0	34.0	11.4	22.1	—	18.5	1,037
444KA088S	DD/Kohler 12V 4000	4	16.0	10.0	0.6	73.0	36.5	13.6	26.6	—	18.5	1,230

Critical

Hospital

Puck-Style

Engine Exhaust Silencers

Dual Inlet, Low Skin Temperature (LST)

Part Number	Fits Engine	Silencer Type	P	A	N	D	K	Y	L	C	J	Weight
471CA684F	CAT 3508B	1	12	6	4.0	62.0	35.0	13.0	22.0	20.5	—	796
471CA884F	CAT 3508B	1	12	8	4.0	62.0	35.0	13.0	22.0	20.5	—	790
471CB886F	CAT 3512B	1	14	8	4.0	64.4	36.2	15.0	27.0	20.6	—	955
471CB086F	CAT 3512B	1	14	10	4.0	64.4	36.2	15.5	27.0	20.6	—	963
471CB888F	CAT 3512B	1	16	8	4.0	74.4	41.2	16.5	29.0	20.6	—	1,304
471CB088F	CAT 3512B	1	16	10	4.0	74.4	41.2	16.5	29.0	20.6	—	1,312
471CC886F	CAT 3516	1	14	8	4.0	64.4	36.2	15.5	27.0	20.5	—	955
471CC086F	CAT 3516	1	14	10	4.0	64.4	36.2	15.5	27.0	20.5	—	963
471CC888F	CAT 3516	1	16	8	4.0	74.4	41.2	16.5	29.0	20.5	—	1,304
471CC088F	CAT 3516	1	16	10	4.0	74.4	41.2	16.5	29.0	20.5	—	1,310
471CC899F	CAT 3516	1	18	8	4.0	84.6	46.3	17.5	31.0	20.5	—	1,623
471CC099F	CAT 3516	1	18	10	4.0	84.6	46.3	17.5	31.0	20.5	—	1,631
473MA580F	Cummins VTA28-G5	3	8	5	4.0	45.0	26.5	10.5	17.0	12.5	2.0	377
473MA582F	Cummins VTA28-G5	3	10	5	4.0	52.0	30.0	12.0	20.0	12.5	2.0	563
472MB682F	Cummins QST30-G1-2	2	10	6	4.0	52.0	30.0	12.0	20.0	12.1	4.2	569
472MC682F	Cummins QST30-G3	2	10	6	4.0	52.0	30.0	12.0	20.0	13.3	4.2	569
472MD684F	Cummins QST30-G3-5	2	12	6	4.0	62.0	35.0	13.0	22.0	13.3	4.2	796
472ME682F	Cummins KTA38-G3	2	10	6	4.0	52.0	30.0	12.0	20.0	13.3	5.7	569
472MF684F	Cummins KTA38-G3-5	2	12	6	4.0	60.0	35.0	13.0	22.0	13.3	5.7	796
473MG684F	Cummins KTA50-G3	3	12	6	4.0	62.0	35.0	13.0	22.0	10.3	13.9	796
473MH686F	Cummins KTA50-G3-4	3	14	6	4.0	64.4	36.2	15.5	27.0	10.3	13.9	947
473MJ686F	Cummins KTA50-G9	3	14	6	4.0	64.4	36.2	15.5	27.0	10.3	13.9	947
474KA086F	DD/Kohler 12V 4000	4	14	10	4.0	64.4	36.2	15.5	27.0	—	18.5	963
474KA088F	DD/Kohler 12V 4000	4	16	10	4.0	74.4	41.2	16.5	29.0	—	18.5	1,312
481CA684F	CAT 3508B	1	12	6	4.0	70.0	39.0	13.0	22.0	20.5	—	1,000
481CA884F	CAT 3508B	1	12	8	4.0	70.0	39.0	13.0	22.0	20.5	—	1,000
481CB886F	CAT 3512B	1	14	8	4.0	70.0	39.0	15.8	27.5	20.6	—	1,144
481CB086F	CAT 3512B	1	14	10	4.0	70.0	39.0	15.8	27.5	20.6	—	1,152
481CB888F	CAT 3512B	1	16	8	4.0	75.0	41.5	18.0	32.0	20.6	—	1,358
481CB088F	CAT 3512B	1	16	10	4.0	75.0	41.5	18.0	32.0	20.6	—	1,366
481CC886F	CAT 3516	1	14	8	4.0	70.0	39.0	15.8	27.5	20.5	—	1,152
481CC086F	CAT 3516	1	14	10	4.0	70.0	39.0	15.8	27.5	20.5	—	1,152
481CC888F	CAT 3516	1	16	8	4.0	75.0	41.5	18.0	32.0	20.5	—	1,358
481CC088F	CAT 3516	1	16	10	4.0	75.0	41.5	18.0	32.0	20.5	—	1,364
481CC899F	CAT 3516	1	18	8	4.0	86.0	47.0	19.0	34.0	20.5	—	1,748
481CC099F	CAT s3516	1	18	10	4.0	86.0	47.0	19.0	34.0	20.5	—	1,756
483MA580F	Cummins VTA28-G5	3	8	5	4.0	52.0	30.0	10.5	17.0	12.5	2.0	552
483MA582F	Cummins VTA28-G5	3	10	5	4.0	59.0	33.5	12.0	20.0	12.5	2.0	754
482MB682F	Cummins QST30-G1-2	2	10	6	4.0	59.0	33.5	12.0	20.0	12.1	4.2	760
482MC682F	Cummins QST30-G3	2	10	6	4.0	59.0	33.5	12.0	20.0	13.3	4.2	760
482MD684F	Cummins QST30-G3-5	2	12	6	4.0	70.0	39.0	13.0	22.0	13.3	4.2	1,000
482ME682F	Cummins KTA38-G3	2	10	6	4.0	59.0	33.5	12.0	20.0	13.3	5.7	760
482MF684F	Cummins KTA38-G3-5	2	12	6	4.0	70.0	39.0	13.0	22.0	13.3	5.7	1,000
483MG684F	Cummins KTA50-G3	3	12	6	4.0	70.0	39.0	13.0	22.0	10.3	13.9	1,000
483MH686F	Cummins KTA50-G3-4	3	14	6	4.0	70.0	39.0	15.8	27.5	10.3	13.9	1,136
483MJ686F	Cummins KTA50-G9	3	14	6	4.0	70.0	39.0	15.8	27.5	10.3	13.9	1,136
484KA086F	DD/Kohler 12V 4000	4	14	10	4.0	70.0	39.0	15.8	27.5	—	18.5	1,152
484KA088F	DD/Kohler 12V 4000	4	16	10	4.0	75.0	41.5	18.0	32.0	—	18.5	1,366

Critical

Hospital

Puck-Style

Engine Exhaust Silencers

Dual Inlet, Low Skin Temperature (LST), Flush Mount

Part Number	Fits Engine	Silencer Type	P	A	N	D	K	Y	L	C	J	Weight
471CA684S	CAT 3508B	1	12.0	6.0	0.5	62.0	35.0	9.5	18.5	20.5	—	806
471CA884S	CAT 3508B	1	12.0	8.0	0.5	62.0	35.0	9.5	18.5	20.5	—	806
471CB886S	CAT 3512B	1	14.0	8.0	0.5	64.4	36.2	12.0	23.2	20.6	—	947
471CB086S	CAT 3512B	1	14.0	10.0	0.6	64.4	36.2	12.0	23.5	20.6	—	953
471CB888S	CAT 3512B	1	16.0	8.0	0.5	74.4	41.2	13.0	25.5	20.6	—	1,296
471CB088S	CAT 3512B	1	16.0	10.0	0.6	74.4	41.2	13.0	25.5	20.6	—	1,302
471CC886S	CAT 3516	1	14.0	8.0	0.5	64.4	36.2	12.0	23.5	20.5	—	947
471CC086S	CAT 3516	1	14.0	10.0	0.6	64.4	36.2	12.0	23.5	20.5	—	953
471CC888S	CAT 3516	1	16.0	8.0	0.5	74.4	41.2	13.0	25.5	20.5	—	1,296
471CC088S	CAT 3516	1	16.0	10.0	0.6	74.4	41.2	13.0	25.5	20.5	—	1,300
471CC899S	CAT 3516	1	18.0	8.0	0.5	84.6	46.3	14.0	27.5	20.5	—	1,615
471CC099S	CAT 3516	1	18.0	10.0	0.6	84.6	46.3	14.0	27.5	20.5	—	1,621
473MA580S	Cummins VTA28-G5	3	8.0	5.0	0.5	45.0	26.5	7.0	13.5	12.5	2.0	372
473MA582S	Cummins VTA28-G5	3	10.0	5.0	0.5	52.0	30.0	8.5	16.5	12.5	2.0	558
472MB682S	Cummins QST30-G1-2	2	10.0	6.0	0.5	52.0	30.0	8.5	16.5	12.1	4.2	563
472MC682S	Cummins QST30-G3	2	10.0	6.0	0.5	52.0	30.0	8.5	16.5	13.3	4.2	563
472MD684S	Cummins QST30-G3-5	2	12.0	6.0	0.5	62.0	35.0	9.5	18.5	13.3	4.2	790
472ME682S	Cummins KTA38-G3	3	10.0	6.0	0.5	52.0	30.0	8.5	16.5	13.3	5.7	563
472MF684S	Cummins KTA38-G3-5	3	12.0	6.0	0.5	62.0	35.0	9.5	18.5	13.3	5.7	790
473MG684S	Cummins KTA50-G3	3	12.0	6.0	0.5	62.0	35.0	9.5	18.5	10.3	13.9	790
473MH686S	Cummins KTA50-G3-4	3	14.0	6.0	0.5	64.4	36.2	12.0	23.5	10.3	13.9	941
473MJ686S	Cummins KTA50-G9	3	14.0	6.0	0.5	64.4	36.2	12.0	23.5	10.3	13.9	941
474KA086S	DD/Kohler 12V 4000	4	14.0	10.0	0.6	64.4	36.2	12.0	23.5	—	18.5	953
474KA088S	DD/Kohler 12V 4000	4	16.0	10.0	0.6	74.4	41.2	13.0	25.5	—	18.5	1,310
481CA684S	CAT 3508B	1	12.0	6.0	0.5	70.0	39.0	9.5	18.5	20.5	—	994
481CA884S	CAT 3508B	1	12.0	8.0	0.5	70.0	39.0	9.5	18.5	20.5	—	992
481CB886S	CAT 3512B	1	14.0	8.0	0.5	70.0	39.0	12.3	24.0	20.6	—	1,136
481CB086S	CAT 3512B	1	14.0	10.0	0.6	70.0	39.0	12.3	24.0	20.6	—	1,142
481CB888S	CAT 3512B	1	16.0	8.0	0.5	75.0	41.5	15.5	28.5	20.6	—	1,350
481CB088S	CAT 3512B	1	16.0	10.0	0.6	75.0	41.5	15.5	28.5	20.6	—	1,356
481CC886S	CAT 3516	1	14.0	8.0	0.5	70.0	39.0	12.3	24.0	20.5	—	1,144
481CC086S	CAT 3516	1	14.0	10.0	0.6	70.0	39.0	12.3	24.0	20.5	—	1,142
481CC888S	CAT 3516	1	16.0	8.0	0.5	75.0	41.5	15.5	28.5	20.5	—	1,350
481CC088S	CAT 3516	1	16.0	10.0	0.6	75.0	41.5	15.5	28.5	20.5	—	1,354
481CC899S	CAT 3516	1	18.0	8.0	0.5	86.0	47.0	16.5	30.5	20.5	—	1,740
481CC099S	CAT 3516	1	18.0	10.0	0.6	86.0	47.0	16.5	30.5	20.5	—	1,746
483MA580S	Cummins VTA28-G5	3	8.0	5.0	0.5	52.0	30.0	7.0	13.5	12.5	2.0	547
483MA582S	Cummins VTA28-G5	3	10.0	5.0	0.5	59.0	33.5	8.5	16.5	12.5	2.0	749
482MB682S	Cummins QST30-G1-2	2	10.0	6.0	0.5	59.0	33.5	8.5	16.5	12.1	4.2	754
482MC682S	Cummins QST30-G3	2	10.0	6.0	0.5	59.0	33.5	8.5	16.5	13.3	4.2	754
482MD684S	Cummins QST30-G3-5	2	12.0	6.0	0.5	70.0	39.0	9.5	18.5	13.3	4.2	994
482ME682S	Cummins KTA38-G3	2	10.0	6.0	0.5	59.0	33.5	8.5	16.5	13.3	5.7	754
482MF684S	Cummins KTA38-G3-5	2	12.0	6.0	0.5	70.0	39.0	9.5	18.5	13.3	5.7	994
483MG684S	Cummins KTA50-G3	3	12.0	6.0	0.5	70.0	39.0	9.5	18.5	10.3	13.9	994
483MH686S	Cummins KTA50-G3-4	3	14.0	6.0	0.5	70.0	39.0	12.3	24.0	10.3	13.9	1,130
483MJ686S	Cummins KTA50-G9	3	14.0	6.0	0.5	70.0	39.0	12.3	24.0	10.3	13.9	1,130
484KA086S	DD/Kohler 12V 4000	4	14.0	10.0	0.6	70.0	39.0	12.3	24.0	—	18.5	1,142
484KA088S	DD/Kohler 12V 4000	4	16.0	10.0	0.6	75.0	41.5	15.5	28.5	—	18.5	1,356

Critical

Hospital